

Berger Realty

Since 1926



Berger Realty, Inc.
55th & Haven Avenue
Ocean City, NJ 08226
609-399-0040
info@bergerrealty.com



B:534 L:12.02 Estelle, Mays Landing, NJ, 08330

Price \$22,500.00



PROPERTY DETAILS

Total Rooms	
Bedrooms	0
Baths Full	0
Baths Half	0
Year Built	
Type	
Block Number	534
Listing #	602050
Taxes	123.00

COMMENTS

...

PROPERTY FEATURES

CONTACT



Ask for Jeff Haas
Berger Realty Inc
109 E 55th St., Ocean City
Call: 609-425-5115
Email to: jsh@bergerrealty.com

Scan to see Property page.



Berger Realty

Since 1926



Berger Realty, Inc.
55th & Haven Avenue
Ocean City, NJ 08226
609-399-0040
info@bergerrealty.com



B:534 L:12.02 Estelle, Mays Landing, NJ, 08330

Price \$22,500.00

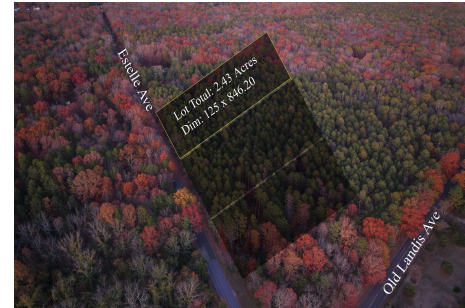

PROPERTY DETAILS

Total Rooms	
Bedrooms	0
Baths Full	0
Baths Half	0
Year Built	
Type	
Block Number	534
Listing #	602050
Taxes	123.00

COMMENTS

...

PROPERTY FEATURES

CONTACT



Ask for Jeff Haas
Berger Realty Inc
109 E 55th St., Ocean City
Call: 609-425-5115
Email to: jsh@bergerrealty.com

Scan to see Property page.

