



Berger Realty, Inc.  
3160 Asbury Avenue  
Ocean City, NJ 08226  
1-877-237-4371 / 609-399-0076  
info@bergerrealty.com



B:534 L:12.02 Estelle, Mays Landing, NJ, 08330

Price \$22,500.00

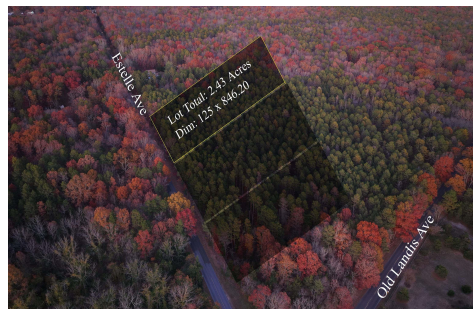

#### PROPERTY DETAILS

|              |        |
|--------------|--------|
| Total Rooms  |        |
| Bedrooms     | 0      |
| Baths Full   | 0      |
| Baths Half   | 0      |
| Year Built   |        |
| Type         |        |
| Block Number | 534    |
| Listing #    | 602050 |
| Taxes        | 123.00 |

#### COMMENTS

...

#### PROPERTY FEATURES

#### CONTACT



Ask for J.K. Hepner, III  
Berger Realty Inc  
3160 Asbury Avenue, Ocean City  
Call: 609-457-9457  
Email to: jkh@bergerrealty.com

Scan to see Property page.



Berger Realty, Inc.  
3160 Asbury Avenue  
Ocean City, NJ 08226  
1-877-237-4371 / 609-399-0076  
info@bergerrealty.com



B:534 L:12.02 Estelle, Mays Landing, NJ, 08330

Price \$22,500.00

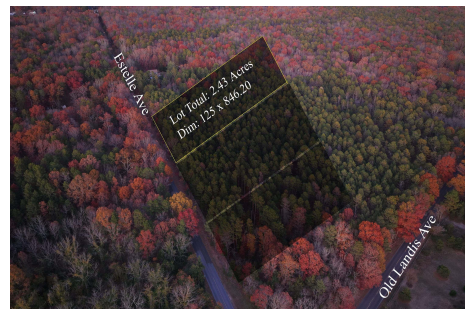

#### PROPERTY DETAILS

|              |        |
|--------------|--------|
| Total Rooms  |        |
| Bedrooms     | 0      |
| Baths Full   | 0      |
| Baths Half   | 0      |
| Year Built   |        |
| Type         |        |
| Block Number | 534    |
| Listing #    | 602050 |
| Taxes        | 123.00 |

#### COMMENTS

...

#### PROPERTY FEATURES

#### CONTACT



Ask for J.K. Hepner, III  
Berger Realty Inc  
3160 Asbury Avenue, Ocean City  
Call: 609-457-9457  
Email to: jkh@bergerrealty.com

Scan to see Property page.

