



Berger Realty, Inc.
3160 Asbury Avenue
Ocean City, NJ 08226
1-877-237-4371 / 609-399-0076
info@bergerrealty.com



Cape May, Mays Landing, NJ, 08330

Price \$95,000.00



PROPERTY DETAILS

Total Rooms	
Bedrooms	0
Baths Full	0
Baths Half	0
Year Built	
Type	
Block Number	626
Listing #	597607
Taxes	992.00

COMMENTS

Buyer is responsible to do their own due diligence as Seller has owned this property for a very long time and makes no warranties if it is considered buildable. If land is considered buildable, it is the responsibility of the buyer to obtain any/all certifications/surveys etc....

PROPERTY FEATURES

CONTACT

SALE



Ask for Bader - Collins Associates
Berger Realty Inc
3160 Asbury Avenue, Ocean City
Call:
Email to: bca@bergerrealty.com
<http://www.BADERCOLLINS.com>

BADERCOLLINS.COM

Scan to see Property page.



Berger Realty, Inc.
3160 Asbury Avenue
Ocean City, NJ 08226
1-877-237-4371 / 609-399-0076
info@bergerrealty.com



Cape May, Mays Landing, NJ, 08330

Price \$95,000.00

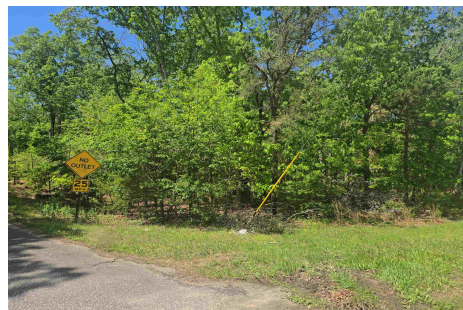

PROPERTY DETAILS

Total Rooms	
Bedrooms	0
Baths Full	0
Baths Half	0
Year Built	
Type	
Block Number	626
Listing #	597607
Taxes	992.00

COMMENTS

Buyer is responsible to do their own due diligence as Seller has owned this property for a very long time and makes no warranties if it is considered buildable. If land is considered buildable, it is the responsibility of the buyer to obtain any/all certifications/surveys etc....

PROPERTY FEATURES

CONTACT

SALE



Ask for Bader - Collins Associates
Berger Realty Inc
3160 Asbury Avenue, Ocean City
Call:
Email to: bca@bergerrealty.com
<http://www.BADERCOLLINS.com>

BADERCOLLINS.COM

Scan to see Property page.

