



Berger Realty, Inc.  
3160 Asbury Avenue  
Ocean City, NJ 08226  
1-877-237-4371 / 609-399-0076  
info@bergerrealty.com



1860 Riverside, Atlantic City, NJ, 08401

Price \$149,000.00

#### PROPERTY DETAILS



Total Rooms	0
Bedrooms	0
Baths Full	0
Baths Half	0
Year Built	
Type	
Block Number	703
Listing #	595479
Taxes	3221.00

#### COMMENTS

***Build Your Dream Home on the Bay! Don't miss this rare opportunity to own a buildable lot in the highly sought-after Venice Park neighborhood. This prime waterfront property offers endless bay views and breathtaking sunsets right from your future doorstep. Whether you're envisioning a custom coastal retreat or a savvy investment, this lot delivers unmatched potential and...***

#### PROPERTY FEATURES

#### CONTACT



Ask for Evelyn "Evie" Schweibinz  
Berger Realty Inc  
3160 Asbury Avenue, Ocean City  
Call:  
Email to: [ems@bergerrealty.com](mailto:ems@bergerrealty.com)

Scan to see Property page.



Berger Realty, Inc.  
3160 Asbury Avenue  
Ocean City, NJ 08226  
1-877-237-4371 / 609-399-0076  
info@bergerrealty.com



1860 Riverside, Atlantic City, NJ, 08401

Price \$149,000.00

#### PROPERTY DETAILS

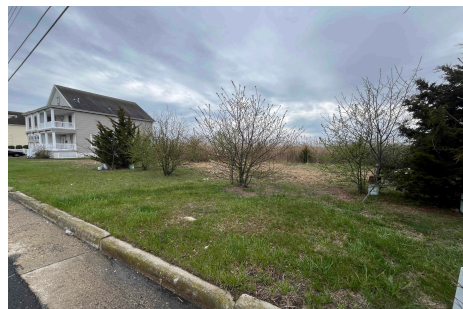

Total Rooms	0
Bedrooms	0
Baths Full	0
Baths Half	0
Year Built	
Type	
Block Number	703
Listing #	595479
Taxes	3221.00

#### COMMENTS

***Build Your Dream Home on the Bay! Don't miss this rare opportunity to own a buildable lot in the highly sought-after Venice Park neighborhood. This prime waterfront property offers endless bay views and breathtaking sunsets right from your future doorstep. Whether you're envisioning a custom coastal retreat or a savvy investment, this lot delivers unmatched potential and...***

#### PROPERTY FEATURES

#### CONTACT



Ask for Evelyn "Evie" Schweibinz  
Berger Realty Inc  
3160 Asbury Avenue, Ocean City  
Call:  
Email to: [ems@bergerrealty.com](mailto:ems@bergerrealty.com)

Scan to see Property page.

