



Berger Realty, Inc.  
3160 Asbury Avenue  
Ocean City, NJ 08226  
1-877-237-4371 / 609-399-0076  
info@bergerrealty.com



Somers Point Rd. / Connell Ave, Egg Harbor Township, NJ,  
08234

Price \$15,000.00

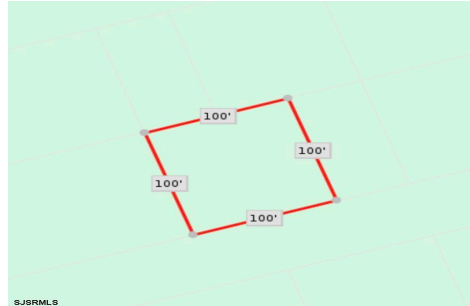

#### PROPERTY DETAILS

|              |        |
|--------------|--------|
| Total Rooms  |        |
| Bedrooms     | 0      |
| Baths Full   | 0      |
| Baths Half   | 0      |
| Year Built   |        |
| Type         |        |
| Block Number | 8004   |
| Listing #    | 594090 |
| Taxes        | 83.00  |

#### COMMENTS

10,000 Square Foot Lot Per Egg Harbor Township zoning. Appropriate for neighboring properties to add square footage to their adjoining property. The Buyer has to perform all due diligence....

#### PROPERTY FEATURES

#### CONTACT



Ask for Veronica "Ronni" Vetro  
Berger Realty Inc  
3160 Asbury Avenue, Ocean City  
Call: 215-806-1817  
Email to: vrv@bergerrealty.com

Scan to see Property page.



Berger Realty, Inc.  
3160 Asbury Avenue  
Ocean City, NJ 08226  
1-877-237-4371 / 609-399-0076  
info@bergerrealty.com



Somers Point Rd. / Connell Ave, Egg Harbor Township, NJ,  
08234

Price \$15,000.00



#### PROPERTY DETAILS

|              |        |
|--------------|--------|
| Total Rooms  |        |
| Bedrooms     | 0      |
| Baths Full   | 0      |
| Baths Half   | 0      |
| Year Built   |        |
| Type         |        |
| Block Number | 8004   |
| Listing #    | 594090 |
| Taxes        | 83.00  |

#### COMMENTS

10,000 Square Foot Lot Per Egg Harbor Township zoning. Appropriate for neighboring properties to add square footage to their adjoining property. The Buyer has to perform all due diligence....

#### PROPERTY FEATURES

#### CONTACT



Ask for Veronica "Ronni" Vetro  
Berger Realty Inc  
3160 Asbury Avenue, Ocean City  
Call: 215-806-1817  
Email to: vrv@bergerrealty.com

Scan to see Property page.

