



Berger Realty, Inc.
3160 Asbury Avenue
Ocean City, NJ 08226
1-877-237-4371 / 609-399-0076
info@bergerrealty.com



Somers Point Rd. / Connell Ave, Egg Harbor Township, NJ,
08234

Price \$15,000.00

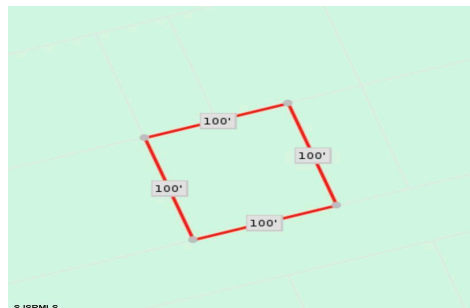

PROPERTY DETAILS

Total Rooms	
Bedrooms	0
Baths Full	0
Baths Half	0
Year Built	
Type	
Block Number	8004
Listing #	594090
Taxes	83.00

COMMENTS

10,000 Square Foot Lot Per Egg Harbor Township zoning. Appropriate for neighboring properties to add square footage to their adjoining property. The Buyer has to perform all due diligence....

PROPERTY FEATURES

CONTACT



Ask for Chris Warren
Berger Realty Inc
3160 Asbury Avenue, Ocean City
Call: 609-432-7694
Email to: caw@bergerrealty.com

Scan to see Property page.



Berger Realty, Inc.
3160 Asbury Avenue
Ocean City, NJ 08226
1-877-237-4371 / 609-399-0076
info@bergerrealty.com



Somers Point Rd. / Connell Ave, Egg Harbor Township, NJ,
08234

Price \$15,000.00



PROPERTY DETAILS

Total Rooms	
Bedrooms	0
Baths Full	0
Baths Half	0
Year Built	
Type	
Block Number	8004
Listing #	594090
Taxes	83.00

COMMENTS

10,000 Square Foot Lot Per Egg Harbor Township zoning. Appropriate for neighboring properties to add square footage to their adjoining property. The Buyer has to perform all due diligence....

PROPERTY FEATURES

CONTACT



Ask for Chris Warren
Berger Realty Inc
3160 Asbury Avenue, Ocean City
Call: 609-432-7694
Email to: caw@bergerrealty.com

Scan to see Property page.

