



Berger Realty, Inc.  
3160 Asbury Avenue  
Ocean City, NJ 08226  
1-877-237-4371 / 609-399-0076  
info@bergerrealty.com



1413 Garfield, Pleasantville, NJ, 08232

Price \$89,900.00

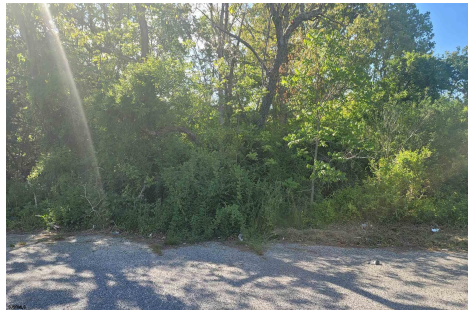

#### PROPERTY DETAILS

Total Rooms	
Bedrooms	0
Baths Full	0
Baths Half	0
Year Built	
Type	
Block Number	1
Listing #	584504
Taxes	1842.00

#### COMMENTS

*Great buildable lot!! Possible two lots if subdivided or one large lot on the corner of Tilton and Garfield Ave....*

#### PROPERTY FEATURES

#### CONTACT



Ask for Ken Sedberry  
Berger Realty Inc  
3160 Asbury Avenue, Ocean City  
Call: 609-442-3850  
Email to: kas@bergerrealty.com  
http://www.buytheshore.com

Scan to see Property page.



Berger Realty, Inc.  
3160 Asbury Avenue  
Ocean City, NJ 08226  
1-877-237-4371 / 609-399-0076  
info@bergerrealty.com



1413 Garfield, Pleasantville, NJ, 08232

Price \$89,900.00

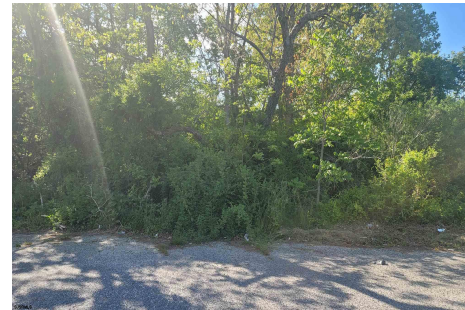

#### PROPERTY DETAILS

Total Rooms	
Bedrooms	0
Baths Full	0
Baths Half	0
Year Built	
Type	
Block Number	1
Listing #	584504
Taxes	1842.00

#### COMMENTS

*Great buildable lot!! Possible two lots if subdivided or one large lot on the corner of Tilton and Garfield Ave....*

#### PROPERTY FEATURES

#### CONTACT



Ask for Ken Sedberry  
Berger Realty Inc  
3160 Asbury Avenue, Ocean City  
Call: 609-442-3850  
Email to: kas@bergerrealty.com  
http://www.buytheshore.com

Scan to see Property page.

