

Berger Realty

Since 1928



Berger Realty, Inc.
3160 Asbury Avenue
Ocean City, NJ 08226
1-877-237-4371 / 609-399-0076
info@bergerrealty.com



Moss Mill, Galloway Township, NJ, 08205

Price \$109,000.00

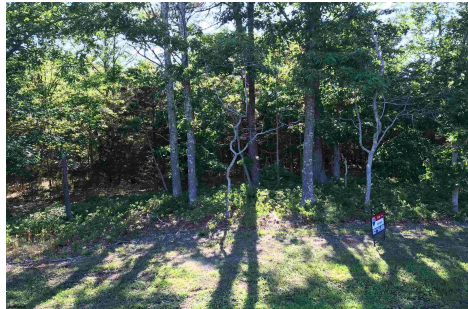

PROPERTY DETAILS

Total Rooms	
Bedrooms	0
Baths Full	0
Baths Half	0
Year Built	
Type	
Block Number	671
Listing #	552257
Taxes	752.00

COMMENTS

4.86 ACRES ON THE CORNER OF POMONA AND MOSS MILL ROAD. ZONED RESORT COMMERCIAL RURAL DISTRACT. ADJACENT TO GARDEN STATE PARKWAY ENTRANCE AND CLOSE TO STOCKEN STATE COLLEGE. zoning allows for motels, hotels, restaurant's...

PROPERTY FEATURES

CONTACT

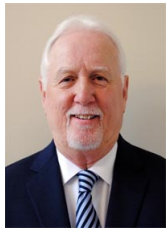

Ask for Thomas Byrne
Berger Realty Inc
3160 Asbury Avenue, Ocean City
Call: 215-327-9152
Email to: tfb@bergerrealty.com

Scan to see Property page.



Berger Realty

Since 1928



Berger Realty, Inc.
3160 Asbury Avenue
Ocean City, NJ 08226
1-877-237-4371 / 609-399-0076
info@bergerrealty.com



Moss Mill, Galloway Township, NJ, 08205

Price \$109,000.00

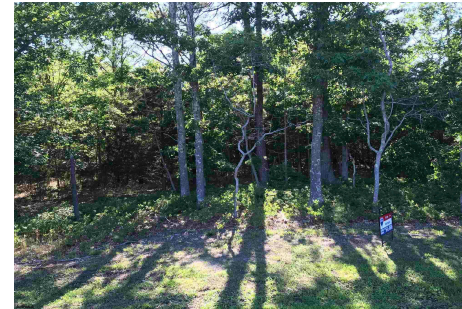

PROPERTY DETAILS

Total Rooms	
Bedrooms	0
Baths Full	0
Baths Half	0
Year Built	
Type	
Block Number	671
Listing #	552257
Taxes	752.00

COMMENTS

4.86 ACRES ON THE CORNER OF POMONA AND MOSS MILL ROAD. ZONED RESORT COMMERCIAL RURAL DISTRACT. ADJACENT TO GARDEN STATE PARKWAY ENTRANCE AND CLOSE TO STOCKEN STATE COLLEGE. zoning allows for motels, hotels, restaurant's...

PROPERTY FEATURES

CONTACT



Ask for Thomas Byrne
Berger Realty Inc
3160 Asbury Avenue, Ocean City
Call: 215-327-9152
Email to: tfb@bergerrealty.com

Scan to see Property page.

