

# Berger Realty

Since 1928



Berger Realty, Inc  
1330 Bay Avenue  
Ocean City, NJ 08226  
609-391-1330/609-391-1300  
info@bergerrealty.com



Moss Mill, Galloway Township, NJ, 08205

Price \$109,000.00

### PROPERTY DETAILS

Total Rooms	
Bedrooms	0
Baths Full	0
Baths Half	0
Year Built	
Type	
Block Number	671
Listing #	552257
Taxes	752.00

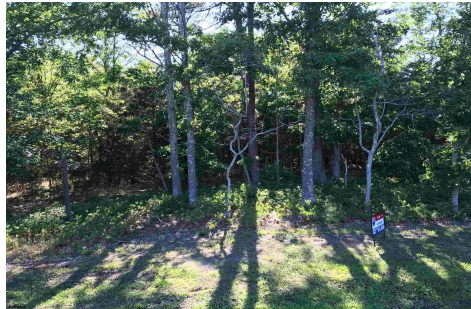

### COMMENTS

4.86 ACRES ON THE CORNER OF POMONA AND MOSS MILL ROAD. ZONED RESORT COMMERCIAL RURAL DISTRACT. ADJACENT TO GARDEN STATE PARKWAY ENTRANCE AND CLOSE TO STOCKEN STATE COLLEGE. zoning allows for motels, hotels, restaurant's...

### PROPERTY FEATURES

### CONTACT



Ask for Joan S. Spencer  
Berger Realty Inc  
1330 Bay Avenue, Ocean City  
Call: 609-204-3027  
Email to: jss@bergerrealty.com

Scan to see Property page.



# Berger Realty

Since 1928



Berger Realty, Inc  
1330 Bay Avenue  
Ocean City, NJ 08226  
609-391-1330/609-391-1300  
info@bergerrealty.com



Moss Mill, Galloway Township, NJ, 08205

Price \$109,000.00

### PROPERTY DETAILS

Total Rooms	
Bedrooms	0
Baths Full	0
Baths Half	0
Year Built	
Type	
Block Number	671
Listing #	552257
Taxes	752.00

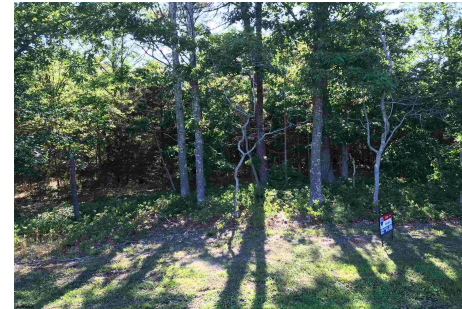

### COMMENTS

4.86 ACRES ON THE CORNER OF POMONA AND MOSS MILL ROAD. ZONED RESORT COMMERCIAL RURAL DISTRACT. ADJACENT TO GARDEN STATE PARKWAY ENTRANCE AND CLOSE TO STOCKEN STATE COLLEGE. zoning allows for motels, hotels, restaurant's...

### PROPERTY FEATURES

### CONTACT



Ask for Joan S. Spencer  
Berger Realty Inc  
1330 Bay Avenue, Ocean City  
Call: 609-204-3027  
Email to: jss@bergerrealty.com

Scan to see Property page.

