

Berger Realty

Since 1928



Ocean 17
1670 Boardwalk
Ocean City, NJ 08226
609-391-0500

oc17@BergerRealty.com



Moss Mill, Galloway Township, NJ, 08205

Price \$109,000.00

PROPERTY DETAILS

Total Rooms	
Bedrooms	0
Baths Full	0
Baths Half	0
Year Built	
Type	
Block Number	671
Listing #	552257
Taxes	752.00

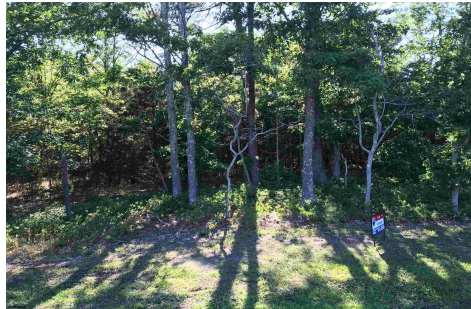

COMMENTS

4.86 ACRES ON THE CORNER OF POMONA AND MOSS MILL ROAD. ZONED RESORT COMMERCIAL RURAL DISTRACT. ADJACENT TO GARDEN STATE PARKWAY ENTRANCE AND CLOSE TO STOCKEN STATE COLLEGE. zoning allows for motels, hotels, restaurant's...

PROPERTY FEATURES

CONTACT



Ask for Dylan Perry
Berger Realty Inc
1670 Boardwalk, Ocean City
Call: 609-675-6737
Email to: dcp@bergerrealty.com

Scan to see Property page.



Berger Realty

Since 1928



Ocean 17
1670 Boardwalk
Ocean City, NJ 08226
609-391-0500

oc17@BergerRealty.com



Moss Mill, Galloway Township, NJ, 08205

Price \$109,000.00

PROPERTY DETAILS

Total Rooms	
Bedrooms	0
Baths Full	0
Baths Half	0
Year Built	
Type	
Block Number	671
Listing #	552257
Taxes	752.00

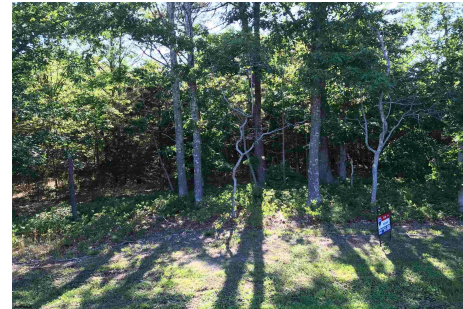

COMMENTS

4.86 ACRES ON THE CORNER OF POMONA AND MOSS MILL ROAD. ZONED RESORT COMMERCIAL RURAL DISTRACT. ADJACENT TO GARDEN STATE PARKWAY ENTRANCE AND CLOSE TO STOCKEN STATE COLLEGE. zoning allows for motels, hotels, restaurant's...

PROPERTY FEATURES

CONTACT

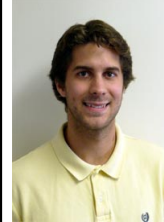

Ask for Dylan Perry
Berger Realty Inc
1670 Boardwalk, Ocean City
Call: 609-675-6737
Email to: dcp@bergerrealty.com

Scan to see Property page.

