

Berger Realty

Since 1928



Berger Realty, Inc.
3160 Asbury Avenue
Ocean City, NJ 08226
1-877-237-4371 / 609-399-0076
info@bergerrealty.com



3 Church, Lower Township, NJ, 08204

Price \$950,000.00

PROPERTY DETAILS

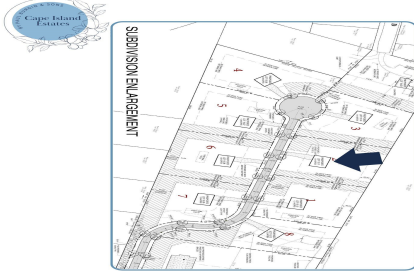

Total Rooms	
Bedrooms	0
Baths Full	0
Baths Half	0
Year Built	
Type	Residential Vacant Lot
Block Number	752.01
Listing #	253222
Taxes	

COMMENTS

Purchase a lot at the new Cape Island Estates. Acre lot with underground utilities run to the property. Perk tests have been done for sewer and well. Sale contingent on signing a construction contract with the Builder. Bring your own plan or work with builder on house options. Property is on the beautiful Cape May Island. 1 1/2 to the beach and town. Bike through the farm ...

PROPERTY FEATURES

CONTACT



Ask for Donna Brown
Berger Realty Inc
3160 Asbury Avenue, Ocean City
Call: 609-425-8352
Email to: dmb@bergerrealty.com

Scan to see Property page.



Berger Realty

Since 1928



Berger Realty, Inc.
3160 Asbury Avenue
Ocean City, NJ 08226
1-877-237-4371 / 609-399-0076
info@bergerrealty.com



3 Church, Lower Township, NJ, 08204

Price \$950,000.00

PROPERTY DETAILS

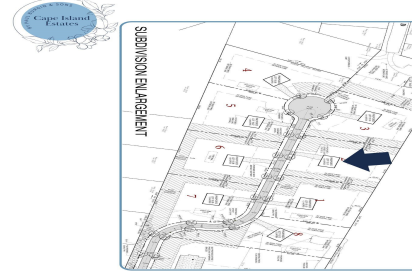

Total Rooms	
Bedrooms	0
Baths Full	0
Baths Half	0
Year Built	
Type	Residential Vacant Lot
Block Number	752.01
Listing #	253222
Taxes	

COMMENTS

Purchase a lot at the new Cape Island Estates. Acre lot with underground utilities run to the property. Perk tests have been done for sewer and well. Sale contingent on signing a construction contract with the Builder. Bring your own plan or work with builder on house options. Property is on the beautiful Cape May Island. 1 1/2 to the beach and town. Bike through the farm ...

PROPERTY FEATURES

CONTACT



Ask for Donna Brown
Berger Realty Inc
3160 Asbury Avenue, Ocean City
Call: 609-425-8352
Email to: dmb@bergerrealty.com

Scan to see Property page.

