



Berger Realty, Inc.
3160 Asbury Avenue
Ocean City, NJ 08226
1-877-237-4371 / 609-399-0076
info@bergerrealty.com



601 Pittsburgh, Cape May, NJ, 08204

Price \$1,500,000.00



PROPERTY DETAILS

Total Rooms	
Bedrooms	0
Baths Full	0
Baths Half	0
Year Built	
Type	Residential Vacant Lot
Block Number	1167
Listing #	251391
Taxes	541.00

COMMENTS

Rare Opportunity to own a large 125 x 125 lot in Cape May with an opportunity to Build your own Custom Home on the Island. Located within blocks of the Cape May Harbor and Marina District and neighboring up against Preserved Land. Seller has DEP Letter of Interpretation to build on this site as Freshwater Wetlands/Waters Boundary Line has been verified by NJDEP as reflec...

PROPERTY FEATURES

CONTACT

Berger Realty Inc
3160 Asbury Ave.
Ocean City, NJ 08226
Call: (609) 399-0076
Email to: info@bergerrealty.com
Web: www.bergerrealty.com

Scan to see Property page.



Berger Realty, Inc.
3160 Asbury Avenue
Ocean City, NJ 08226
1-877-237-4371 / 609-399-0076
info@bergerrealty.com



601 Pittsburgh, Cape May, NJ, 08204

Price \$1,500,000.00

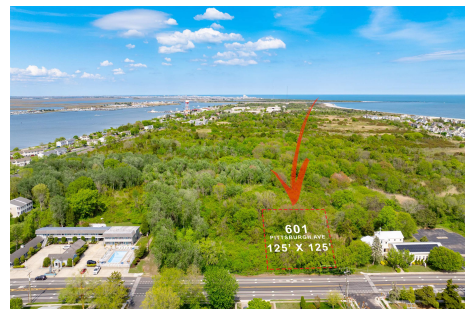

PROPERTY DETAILS

Total Rooms	
Bedrooms	0
Baths Full	0
Baths Half	0
Year Built	
Type	Residential Vacant Lot
Block Number	1167
Listing #	251391
Taxes	541.00

COMMENTS

Rare Opportunity to own a large 125 x 125 lot in Cape May with an opportunity to Build your own Custom Home on the Island. Located within blocks of the Cape May Harbor and Marina District and neighboring up against Preserved Land. Seller has DEP Letter of Interpretation to build on this site as Freshwater Wetlands/Waters Boundary Line has been verified by NJDEP as reflec...

PROPERTY FEATURES

CONTACT

Berger Realty Inc
3160 Asbury Ave.
Ocean City, NJ 08226
Call: (609) 399-0076
Email to: info@bergerrealty.com
Web: www.bergerrealty.com

Scan to see Property page.

