



Berger Realty, Inc
1330 Bay Avenue
Ocean City, NJ 08226
609-391-1330/609-391-1300
info@bergerrealty.com



609 Pittsburgh, Cape May, NJ, 08204

Price \$1,500,000.00

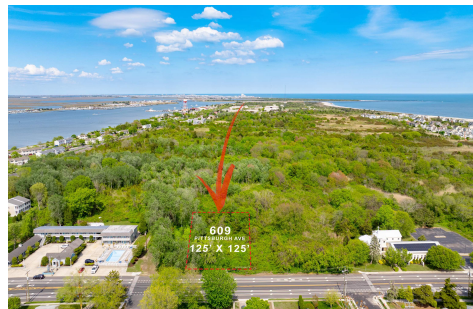

PROPERTY DETAILS

Total Rooms	
Bedrooms	0
Baths Full	0
Baths Half	0
Year Built	
Type	Residential Vacant Lot
Block Number	1167
Listing #	251389
Taxes	541.00

COMMENTS

Rare Opportunity to own a large 125 x 125 lot in Cape May with an opportunity to Build your own Custom Home on the Island. Located within blocks of the Cape May Harbor and Marina District and neighboring up against Preserved Land. Walk to several shops, The South Jersey and Cape May Marina's and Restaurants like the nostalgic Lobster House, Mayer's, C-View, and Lucky B...

PROPERTY FEATURES

CONTACT

Ask for John McElhiney
Berger Realty Inc
1330 Bay Avenue, Ocean City
Call:
Email to: jjm@bergerrealty.com

Scan to see Property page.



Berger Realty, Inc
1330 Bay Avenue
Ocean City, NJ 08226
609-391-1330/609-391-1300
info@bergerrealty.com



609 Pittsburgh, Cape May, NJ, 08204

Price \$1,500,000.00

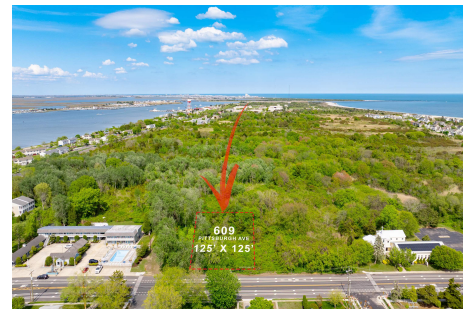

PROPERTY DETAILS

Total Rooms	
Bedrooms	0
Baths Full	0
Baths Half	0
Year Built	
Type	Residential Vacant Lot
Block Number	1167
Listing #	251389
Taxes	541.00

COMMENTS

Rare Opportunity to own a large 125 x 125 lot in Cape May with an opportunity to Build your own Custom Home on the Island. Located within blocks of the Cape May Harbor and Marina District and neighboring up against Preserved Land. Walk to several shops, The South Jersey and Cape May Marina's and Restaurants like the nostalgic Lobster House, Mayer's, C-View, and Lucky B...

PROPERTY FEATURES

CONTACT

Ask for John McElhiney
Berger Realty Inc
1330 Bay Avenue, Ocean City
Call:
Email to: jjm@bergerrealty.com

Scan to see Property page.

