

Berger Realty

Since 1928



Berger Realty, Inc.
3160 Asbury Avenue
Ocean City, NJ 08226
1-877-237-4371 / 609-399-0076
info@bergerrealty.com



0 Chelsea Road
Absecon, NJ 08201

Asking \$158,500.00

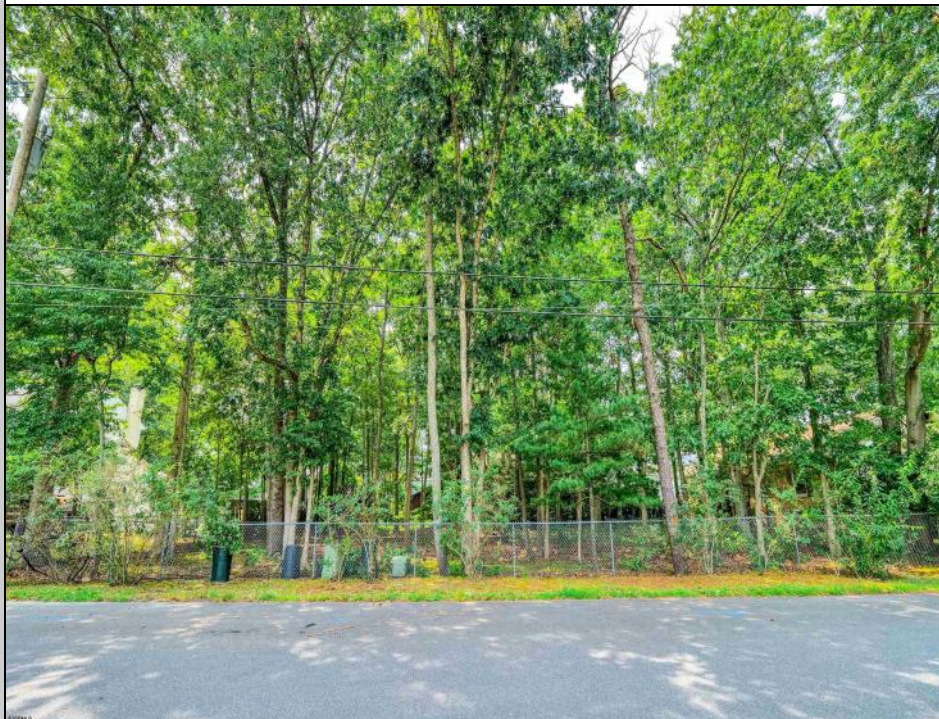

COMMENTS

****NEW LISTING!**** Welcome to one of the last REMAINING VACANT LOTS in the HIGHLY SOUGHT AFTER ABSECON ESTATES!! This EXCEPTIONAL property presents a rare opportunity to build your dream home. Meeting requirements to be a fully buildable lot with ALL UTILITIES AVAILABLE at the street (water, sewer, electric, gas) Surrounded by elegant custom homes on a quiet, tree-lined street! Whether you're a developer looking for a premium parcel or a homeowner with a vision, this property offers the perfect canvas in a PRIME LOCATION. Contingent upon the buyer of the home on 718 Blenheim Ave (also available at \$449,500) having the first rights to purchase the property. THIS IS SIMPLY ONE OF A KIND!!

PROPERTY DETAILS



Ask for John Greiner
Berger Realty Inc
3160 Asbury Avenue, Ocean City
Call: 609-399-0076
Email to: jag@bergerrealty.com

