

Berger Realty

Since 1928



Berger Realty, Inc
 1330 Bay Avenue
 Ocean City, NJ 08226
 609-391-1330/609-391-1300
 info@bergerrealty.com



106 Leo
Egg Harbor Township, NJ 08234

Asking \$39,999.00

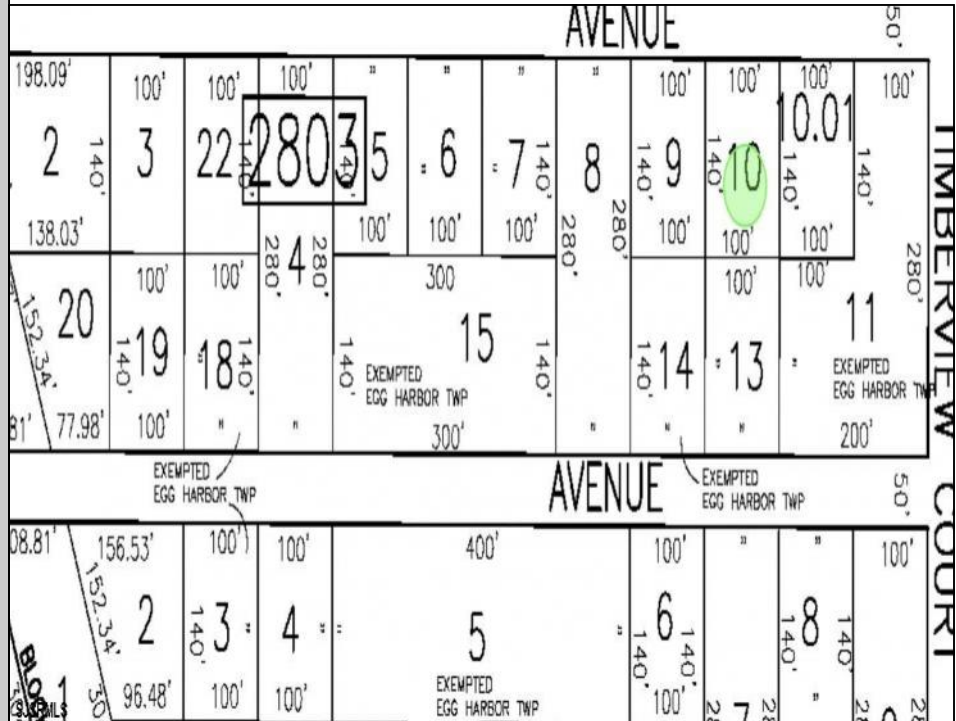

COMMENTS

SELLER DOES NOT HAVE ANY APPROVALS. BUYER MUST DO THEIR OWN DUE DILIGENCE. Residential lot in understated neighborhood at the end of Leo Avenue. A 1/4 Pineland credit due to be purchased for individual lot sales. For multiple lot sales, the Buyer must do their own due diligence. Utilities are available. BUYER MUST DO THEIR OWN DUE DILIGENCE.

PROPERTY DETAILS



Ask for John Tonkinson
 Berger Realty Inc
 1330 Bay Avenue, Ocean City
 Call: 609-391-1330
 Email to: jtn@bergerrealty.com

