

# Berger Realty

Since 1928



Berger Realty, Inc.  
 3160 Asbury Avenue  
 Ocean City, NJ 08226  
 1-877-237-4371 / 609-399-0076  
 info@bergerrealty.com



106 Leo  
 Egg Harbor Township, NJ 08234

Asking \$39,999.00

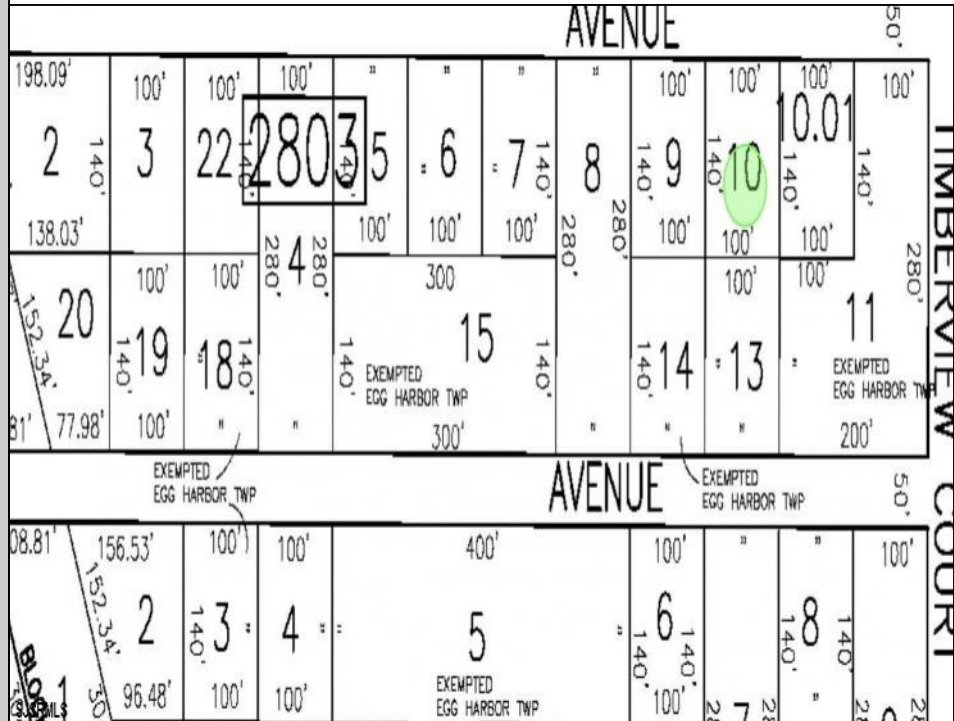

### COMMENTS

SELLER DOES NOT HAVE ANY APPROVALS. BUYER MUST DO THEIR OWN DUE DILIGENCE. Residential lot in understated neighborhood at the end of Leo Avenue. A 1/4 Pineland credit due to be purchased for individual lot sales. For multiple lot sales, the Buyer must do their own due diligence. Utilities are available. BUYER MUST DO THEIR OWN DUE DILIGENCE.

### PROPERTY DETAILS



Ask for J.K. Hepner, III  
 Berger Realty Inc  
 3160 Asbury Avenue, Ocean City  
 Call: 609-399-0076  
 Email to: jkh@bergerrealty.com

