

Berger Realty

Since 1928

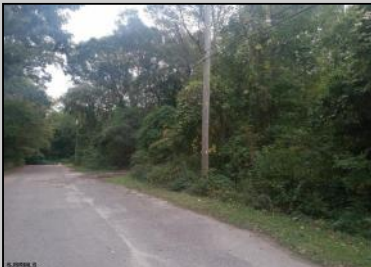

Berger Realty, Inc.
3160 Asbury Avenue
Ocean City, NJ 08226
1-877-237-4371 / 609-399-0076
✉ info@bergerrealty.com



121 Anna St
Cape May Court House, NJ 08210

Asking \$22,500.00



SJSRMLS

COMMENTS

Buildable lot being sold with in progress Letter of Interpretation from Dept of Environmental Protection allowing development on existing wetlands. Buyer is advised to due their own due diligence and Buyer will be responsible for U&O. Being sold as a package with 119 E Anna. Contact Listing Agent with questions, interest, etc.

PROPERTY DETAILS



Ask for Lureen "Lani" Calcara
Berger Realty Inc
3160 Asbury Avenue, Ocean City
Call: 609-399-0076
Email to: luc@bergerrealty.com

