

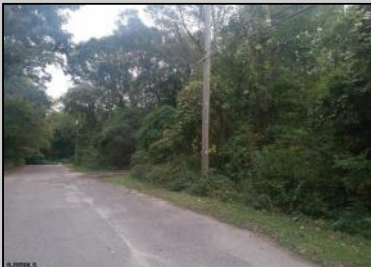

121 Anna St
Cape May Court House, NJ 08210

Asking \$25,000.00



SJSRMLS

COMMENTS

Buildable lot being sold with Letter of Interpretation from Dept of Environmental Protection allowing development on existing wetlands. Buyer is advised to due their own due diligence and Buyer will be responsible for U&O. Being sold as a package with 119 E Anna. Contact Listing Agent with questions, interest, etc.

PROPERTY DETAILS



Ask for Gary Bingham
Berger Realty Inc
109 E 55th St., Ocean City
Call: 609-399-4211
Email to: gsb@bergerrealty.com

