

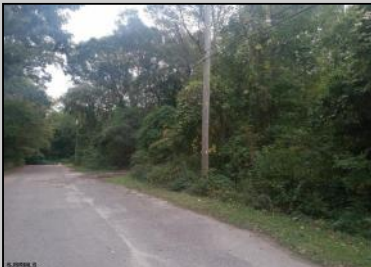

119 Anna St
Cape May Court House, NJ 08210

Asking \$25,000.00



SJSRMLS

COMMENTS

Buildable lot being sold with Letter of Interpretation from Dept of Environmental Protection allowing development on existing wetlands. Buyer is advised to due their own due diligence and Buyer will be responsible for U&O. Being sold as a package with 121 E Anna. Contact Listing Agent with questions, interest, etc.

PROPERTY DETAILS



Ask for Kathy Errickson
Berger Realty Inc
109 E 55th St., Ocean City
Call: 609-399-4211
Email to: kae@bergerrealty.com

