

# Berger Realty

Since 1928

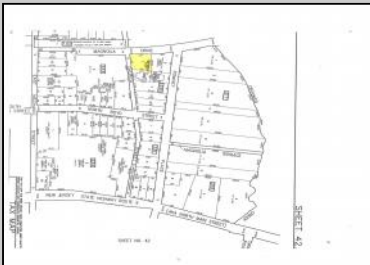

Berger Realty, Inc.  
3160 Asbury Avenue  
Ocean City, NJ 08226  
1-877-237-4371 / 609-399-0076  
info@bergerrealty.com



24 Church  
Cape May Court House, NJ 08210

Asking \$900,000.00



## COMMENTS

Development Opportunity - Looking for a prime location; here it is! Situated in an ideal hub of Cape May Court House close to stores, restaurants, golf, medical facilities and only minutes away from the beach! Presently a business is located on the property with city water and sewer. This 112 x 135 lot has frontage on 2 streets.

## PROPERTY DETAILS

Exterior Wood/Frame	OutsideFeatures Storage Building	ParkingGarage 1 To 5 Spaces	OtherRooms Office Space Avail
------------------------	-------------------------------------	--------------------------------	----------------------------------

InteriorFeatures 220 Volt Electricity Three Phase Electric	Heating Gas Natural Forced Air	Cooling Other (See Remarks)	Water City
--	--------------------------------------	--------------------------------	---------------

Sewer  
City



Ask for Dawn Warren  
Berger Realty Inc  
3160 Asbury Avenue, Ocean City  
Call: 609-399-0076  
Email to: dew@bergerrealty.com

